

Contact insert M23 Signal - 6-pole (solder)

Item number 7001906104

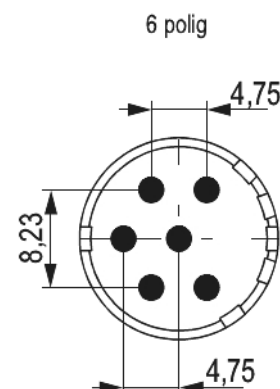
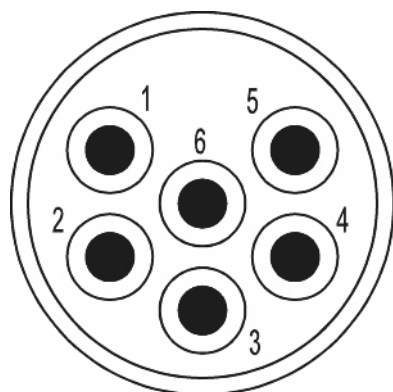

Technical data

Characteristic of connection	Solder
Number of poles	6
Pole picture	6
Insert	Socket
colour	white
Material insulating body	PA 6 , PBT
Number of contacts signal	6
Contact-Ø signal	2 mm
Nominal current signal	20 A
Nominal voltage at degree of pollution 3 signal	300 V~
Test voltage signal	2500 V~
Insulation resistance signal	> 10 ¹⁰ Ohm
max. contact resistance signal	3 mOhm
max. contact resistance power	3 mOhm
Degree of Protection	3



Contact insert M23 Signal - 6-pole (solder)

Item number 7001906104

Flammability

V-0 (UL 94)

Contact insert M23 Signal - 6-pole (solder)

Item number 7001906104

Commercial data

Packaging Unit	20
EAN code	4033878500255
Weight	0.00246 kg
ETIM 7	EC003557
eCl@ss 10.1	27440223
Customs tariff number	85366990

Note:

