

Contact insert M23 Signal - 6-pole

Item number 7003906101

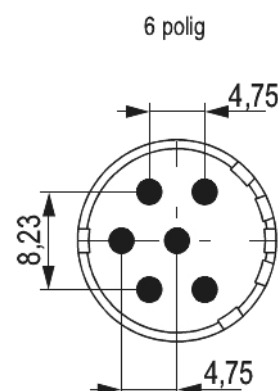
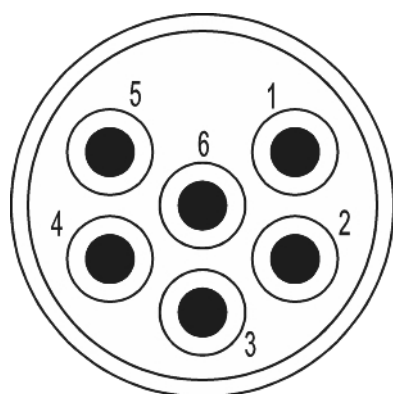

Technical data

| | |
|---|------------------------|
| Characteristic of connection | Crimp |
| Number of poles | 6 |
| Pole picture | 6 |
| Insert | Pin |
| colour | white |
| Material insulating body | PA 6 , PBT |
| Number of contacts signal | 6 |
| Contact-Ø signal | 2 mm |
| Nominal current signal | 20 A |
| Nominal voltage at degree of pollution 3 signal | 300 V~ |
| Test voltage signal | 2500 V~ |
| Insulation resistance signal | > 10 ¹⁰ Ohm |
| max. contact resistance signal | 3 mOhm |
| max. contact resistance power | 3 mOhm |
| Degree of Protection | 3 |



Contact insert M23 Signal - 6-pole

Item number 7003906101

| | |
|---------------------------------|-------------|
| Flammability | V-0 (UL 94) |
| Suitable Signal contacts | 7010902001 |

Contact insert M23 Signal - 6-pole

Item number 7003906101

Commercial data

| | |
|-----------------------|---------------|
| Packaging Unit | 100 |
| EAN code | 4033878501276 |
| Weight | 0.00146 kg |
| ETIM 7 | EC003557 |
| eCl@ss 10.1 | 27440223 |
| Customs tariff number | 85472000 |

Note:

