

# Contact insert M23 Signal - 17-pole

Item number 7003917102

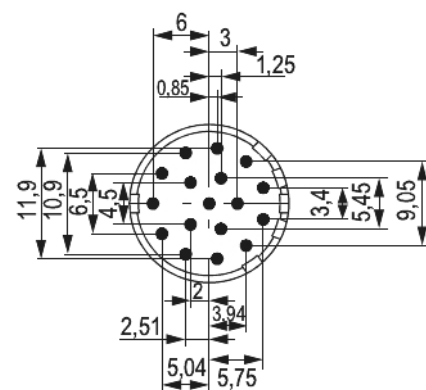
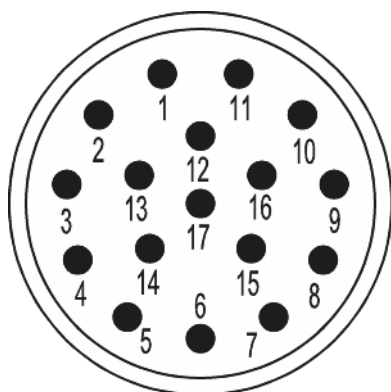

## Technical data

Characteristic of connection	Crimp
Number of poles	17
Pole picture	17
Insert	Socket
colour	white
Material insulating body	PA 6 , PBT
Number of contacts signal	17
Contact-Ø signal	1 mm
Nominal current signal	8 A
Nominal voltage at degree of pollution 3 signal	160 V~
Test voltage signal	1500 V~
Insulation resistance signal	> 10 <sup>6</sup> Ohm
max. contact resistance signal	3 mOhm
max. contact resistance power	3 mOhm
Degree of Protection	3



# Contact insert M23 Signal - 17-pole

Item number 7003917102

<b>Flammability</b>	V-0 (UL 94)
<b>Suitable Signal contacts</b>	7010901002 , 7010901012 , 7010901022

# Contact insert M23 Signal - 17-pole

Item number 7003917102

## Commercial data

Packaging Unit	100
EAN code	4033878501429
Weight	0.00146 kg
ETIM 7	EC003557
eCl@ss 10.1	27440223
Customs tariff number	85472000

## Note:

