

# Contact insert M23 Signal - 9-pole

Item number 7003981101

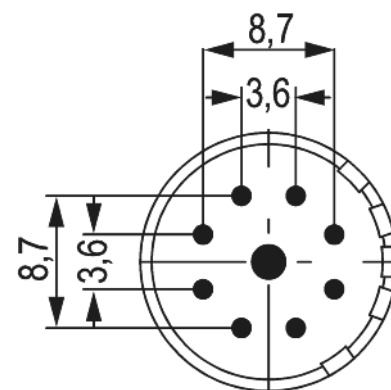
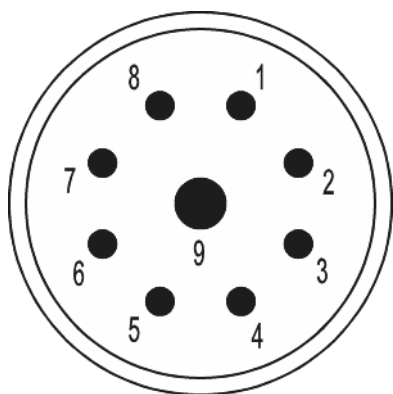

## Technical data

Characteristic of connection	Crimp
Number of poles	9
Pole picture	8 + 1
Insert	Pin
colour	white
Material insulating body	PA 6 , PBT
Number of contacts signal	8
Number of contacts power	1
Contact-Ø signal	1 mm
Contact-Ø power	2 mm
Terminal cross section power	0.75 - 2,5 mm <sup>2</sup>
Nominal current power	20 A
Nominal current signal	8 A
Nominal voltage at degree of pollution 3 signal	200 V <sup>~</sup>

# Contact insert M23 Signal - 9-pole

Item number 7003981101

Nominal voltage at degree of pollution 3 power	200 V~
Test voltage signal	2500 V~
Test voltage power	2500 V~
Insulation resistance signal	> 10 <sup>10</sup> Ohm
Insulation resistance power	> 10 <sup>10</sup> Ohm
max. contact resistance signal	3 mOhm
max. contact resistance power	3 mOhm
Degree of Protection	3
Flammability	V-0 (UL 94)

# Contact insert M23 Signal - 9-pole

Item number 7003981101

## Commercial data

Packaging Unit	100
EAN code	4033878501542
Weight	0.0022 kg
ETIM 7	EC003557
eCl@ss 10.1	27440223
Customs tariff number	85472000

## Note:

