

Contact M16 / M23 Signal crimp pin 1,5 mm

Item number 7010901501

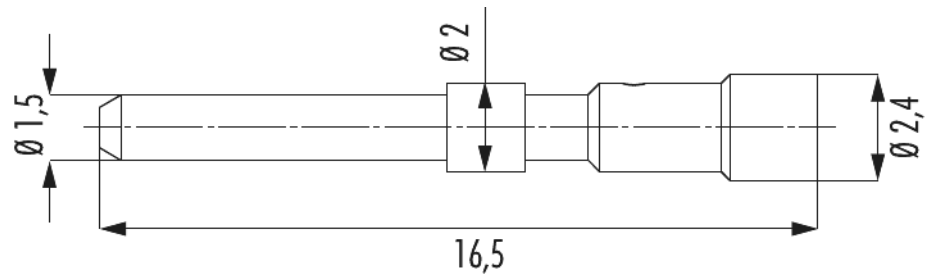

Technical data

Characteristic of connection	Crimp
Insert	Pin
Crimp contact	Crimp pin signal 1,5 mm machined
Material contact	Copper-zinc alloy
Material contact surface	nickel, gold plated (0.25 µm)
Contact-Ø signal	1.5 mm
Length (L)	16.5 mm
Contact-Ø crimping range	2.4 mm
Crimp range	0.14 - 1 mm ²
Suitable crimping tool	7000900904

Contact M16 / M23 Signal crimp pin 1,5 mm

Item number 7010901501

Commercial data

Packaging Unit	100
EAN code	4033878502075
Weight	0.00027 kg
ETIM 7	EC000796
eCl@ss 10.1	27440204
Customs tariff number	85366990

Note:

