

# Contact M16 / M23 Signal crimp socket 1,25 mm

Item number 7010981202

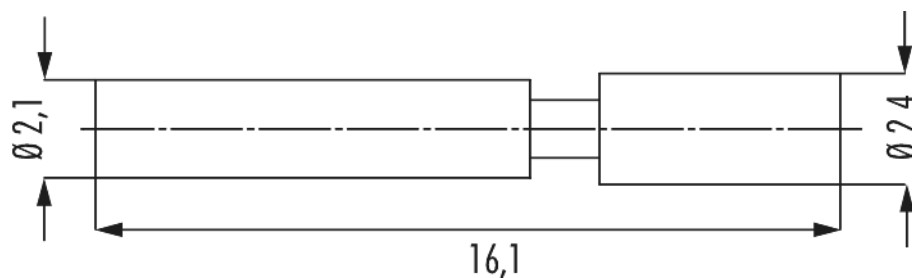
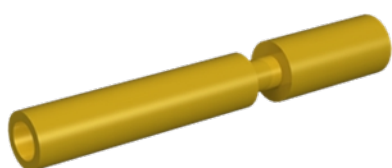

## Technical data

Characteristic of connection	Crimp
Insert	Socket
Crimp contact	Crimp socket signal 1,25 mm machined
Material contact	Copper-zinc alloy
Material contact surface	nickel, gold plated (0.25 $\mu\text{m}$ )
Contact- $\varnothing$ signal	1.25 mm
Length (L)	16.1 mm
Contact- $\varnothing$ crimping range	2.4 mm
Crimp range	0.5 - 1.5 mm <sup>2</sup>
Suitable crimping tool	7000900904

# Contact M16 / M23 Signal crimp socket 1,25 mm

Item number 7010981202

## Commercial data

Packaging Unit	100
EAN code	4033878502341
Weight	0.00026 kg
ETIM 7	EC000796
eCl@ss 10.1	27440204
Customs tariff number	85366990

Note:

