

Contact M16 / M23 Signal crimp pin 2 mm

Item number 7010982001

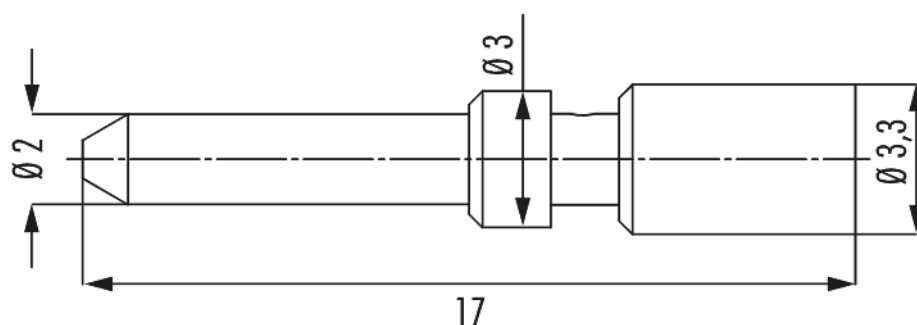
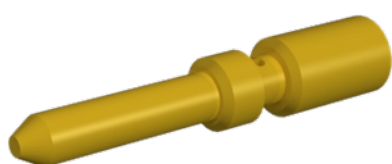

Technical data

Characteristic of connection	Crimp
Insert	Pin
Crimp contact	Crimp pin signal 2 mm machined
Material contact	Copper-zinc alloy
Material contact surface	nickel, gold plated (0.25 µm)
Contact-Ø signal	2 mm
Length (L)	17 mm
Contact-Ø crimping range	3.3 mm
Crimp range	1 - 2.5 mm ²
Suitable crimping tool	7000900904

Contact M16 / M23 Signal crimp pin 2 mm

Item number 7010982001

Commercial data

Packaging Unit	100
EAN code	4033878502396
Weight	0.00057 kg
ETIM 7	EC000796
eCl@ss 10.1	27440204
Customs tariff number	85366990

Note:

